

■ 계획개요

대지면적	591	m <sup>2</sup>
건축면적	270.25	m <sup>2</sup>
건폐율	45.72	%
용적률	262.64	%
지상층 바닥면적	1층	270.25 m <sup>2</sup>
	2층	270.25 m <sup>2</sup>
	3층	270.25 m <sup>2</sup>
	4층	263.5 m <sup>2</sup>
	5층	251 m <sup>2</sup>
	6층	227 m <sup>2</sup>
연면적	1,552.25	m <sup>2</sup>

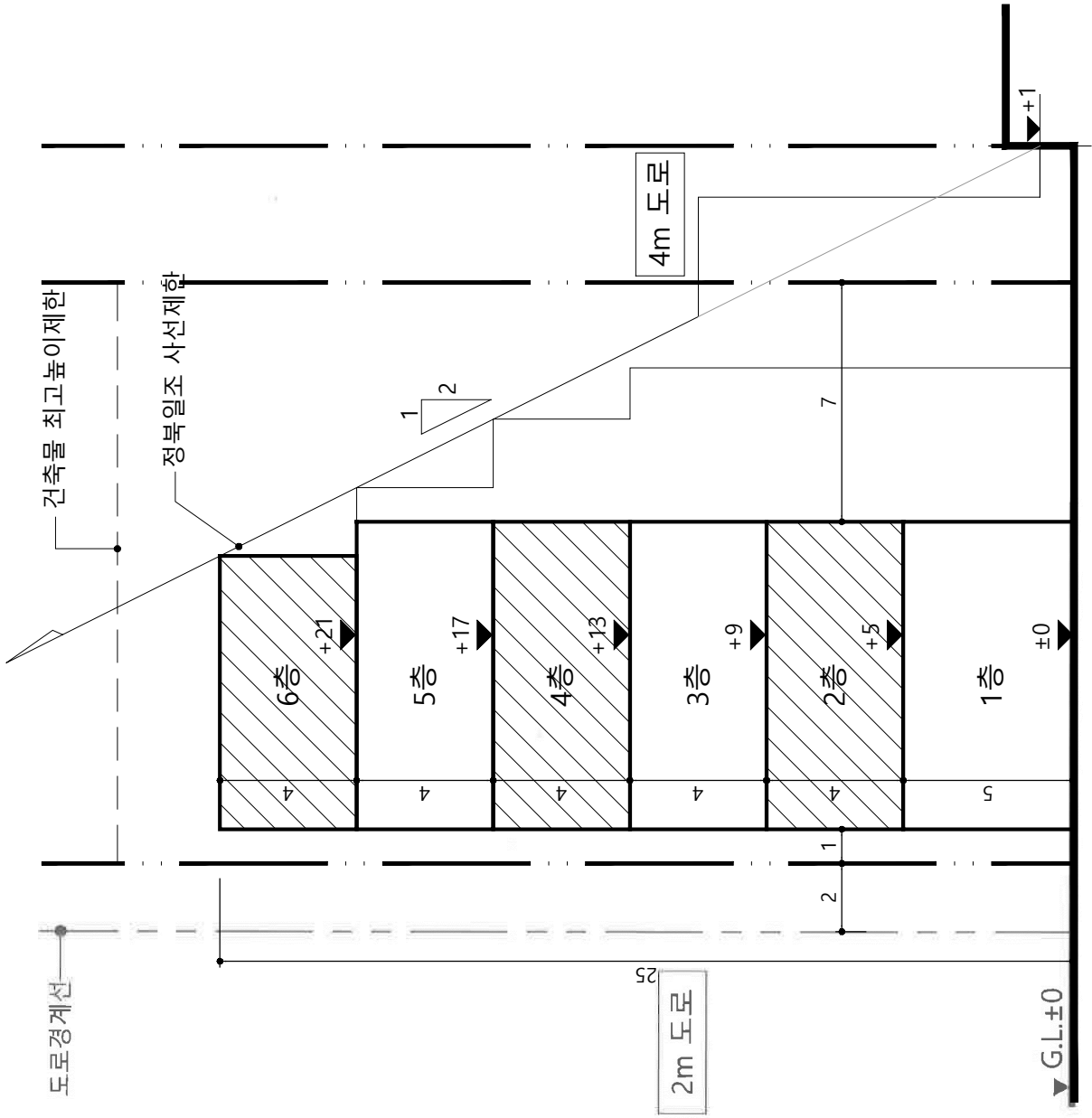

A-A' 단면도  
축척 : 1/200

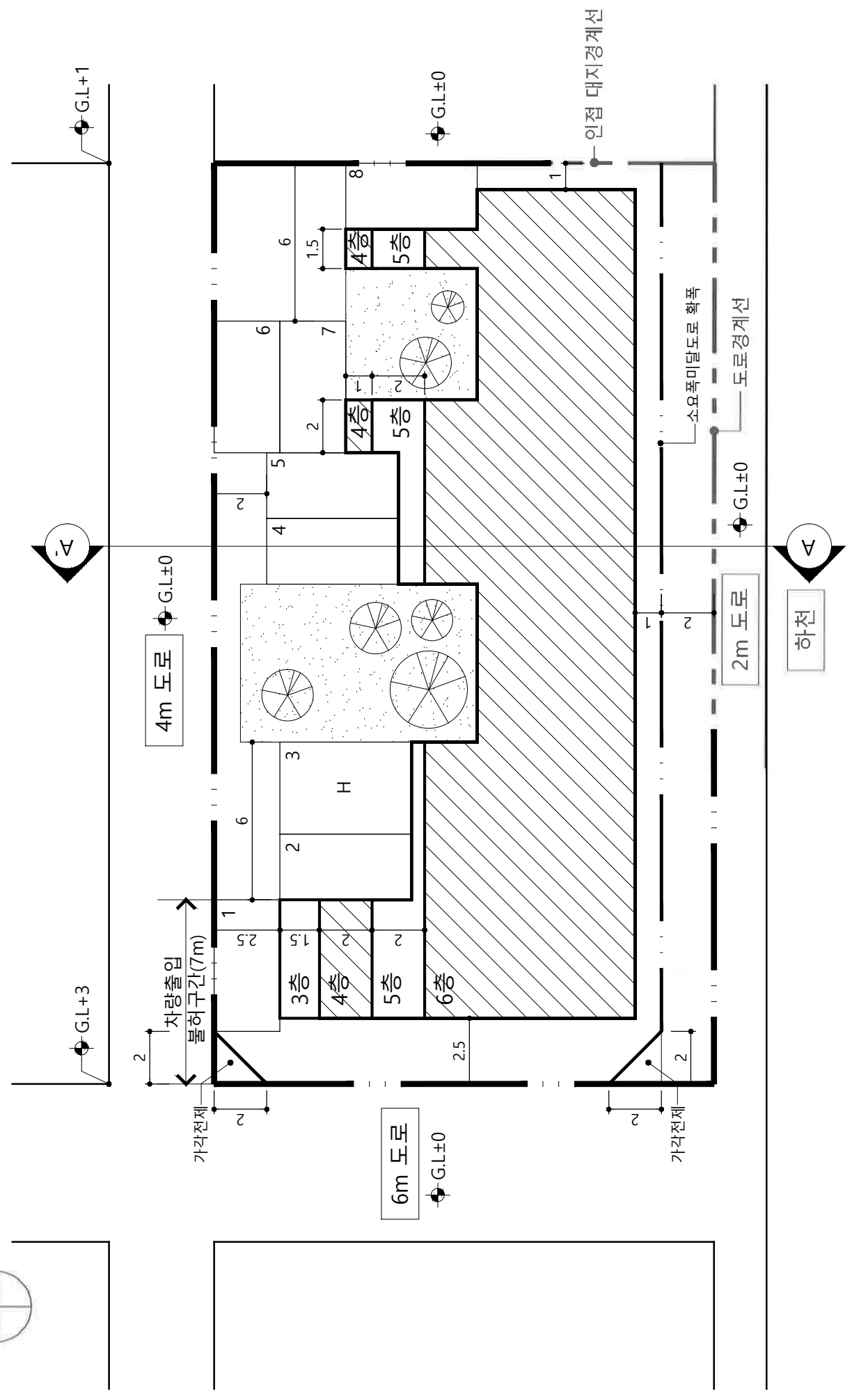
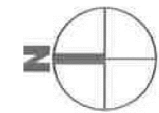

하천

배치도  
축척 : 1/200